

Duplin County 1 - 6

| | |
|--|----------------|
| PROJECT REFERENCE NO. 2022CPT.03.04.10311, ETC. | SHEET NO. 1 |
|--|----------------|

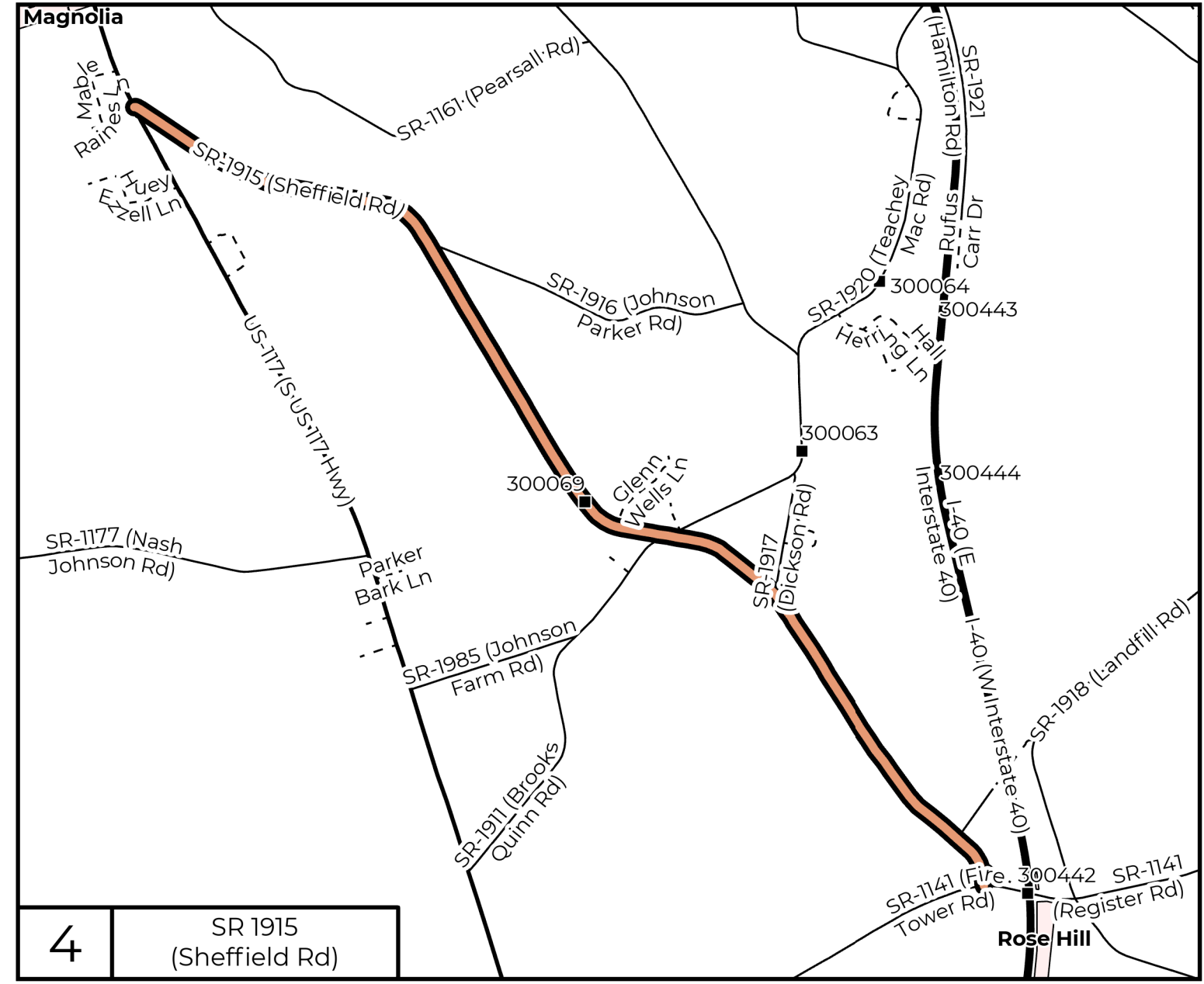

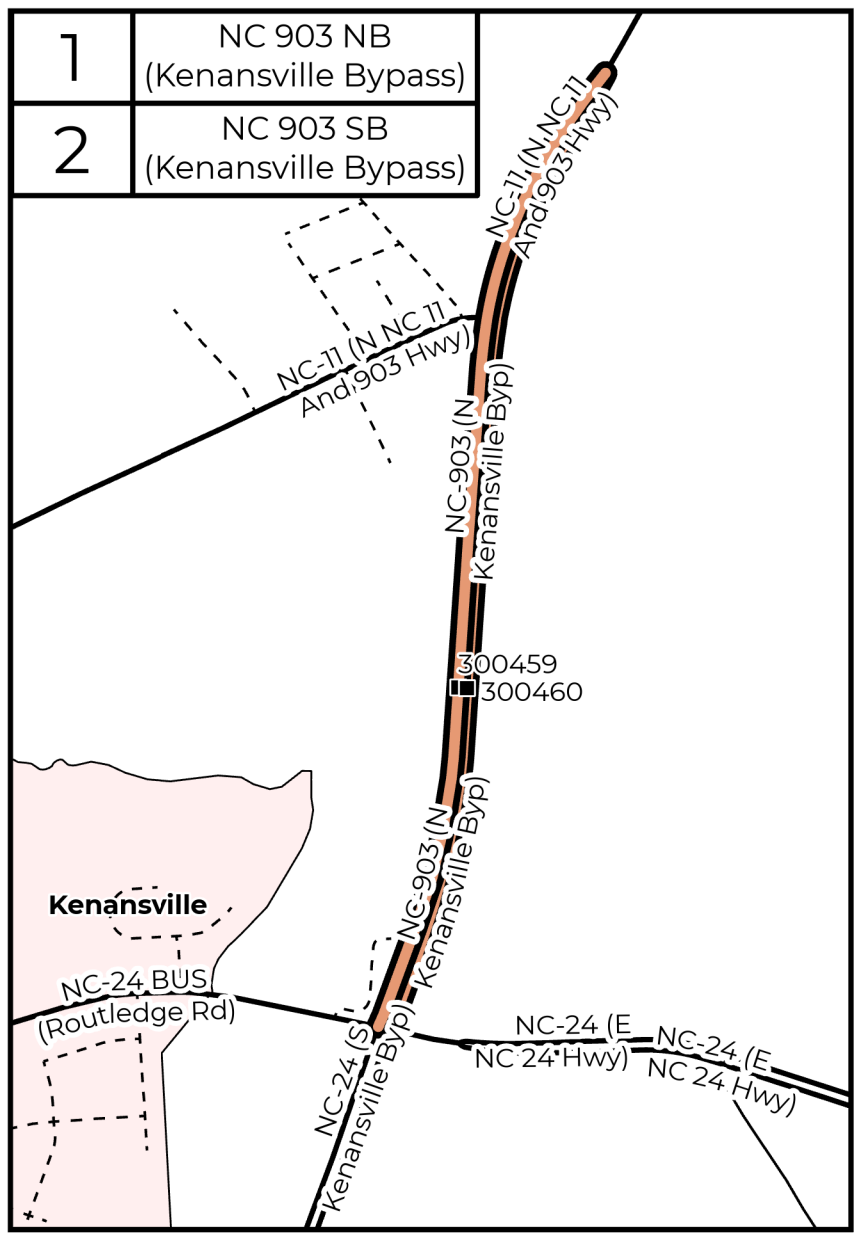
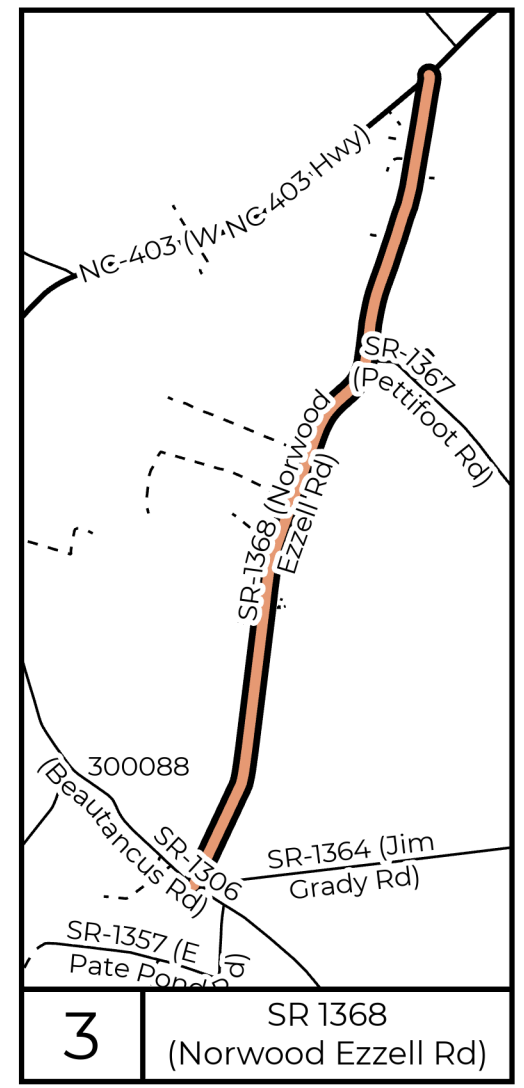
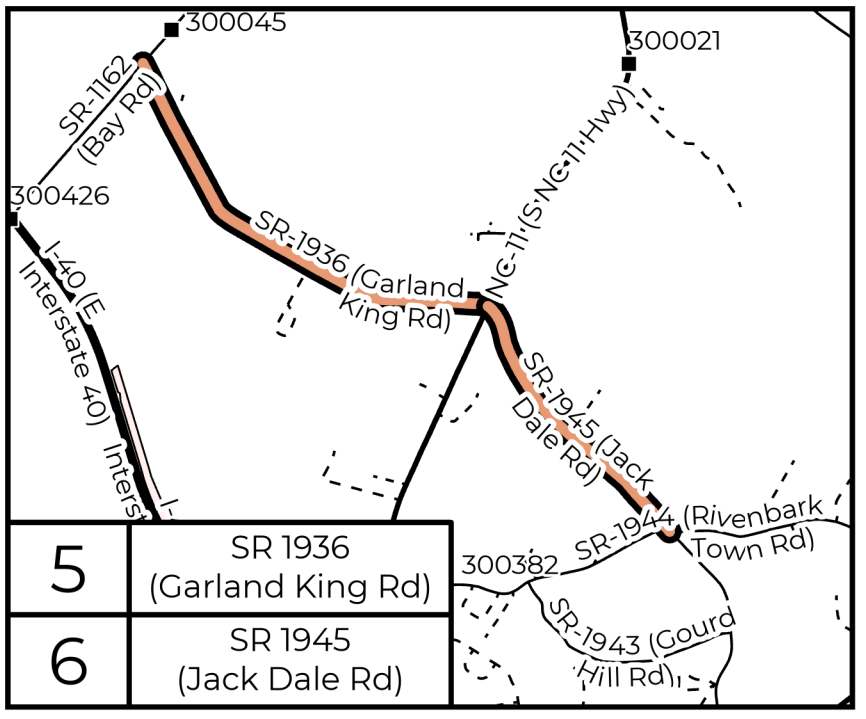
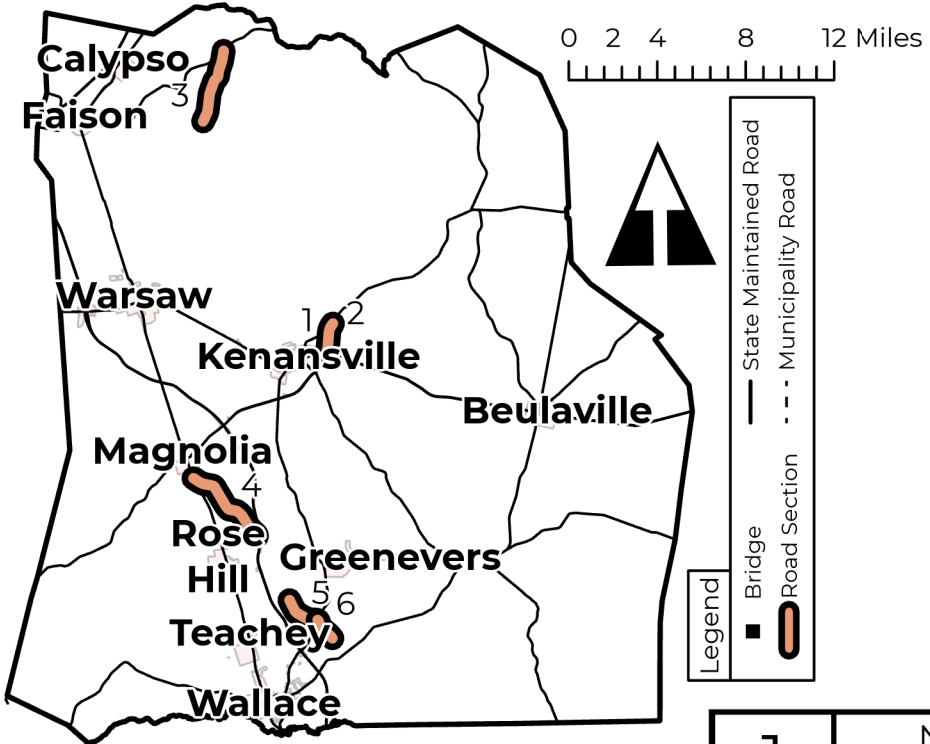
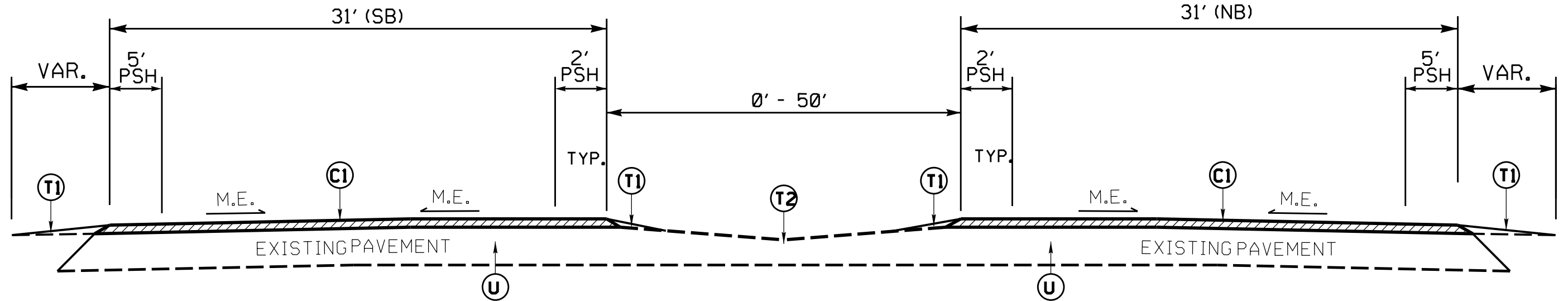

TYPICAL SECTION NO. 1

MAP NO. 2
 NC 11 HWY. / NC 903 HWY. (N. KENANSVILLE BYP.)
 MP 13.09 - MP 18.20

MAP NO. 1
 NC 903 HWY. (N. KENANSVILLE BYP.)/NC 11 HWY.
 MP 17.27 - MP 20.86

NO ASPHALT WORK ON
 BRIDGE NO. 460

NO ASPHALT WORK ON
 BRIDGE NO. 460

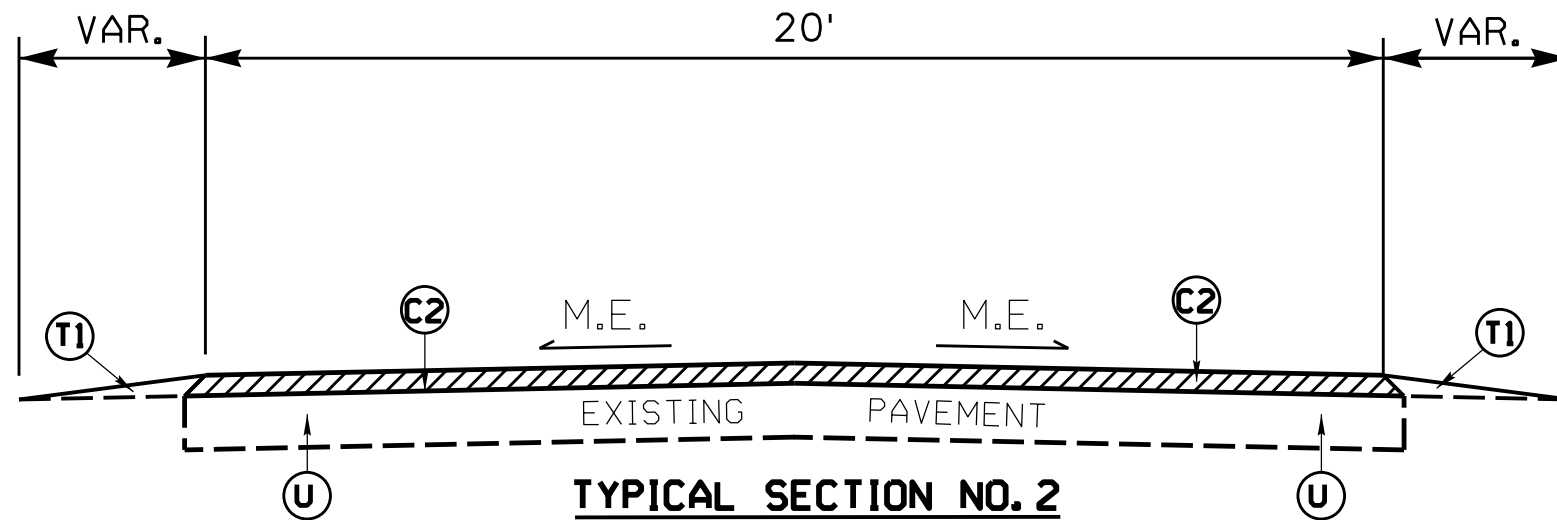

TYPICAL SECTION NO. 2

MAP NO. 3
 SR 1368 (NORWOOD EZZELL RD.)
 MP 0.02 - MP 3.36

MAP NO. 4
 SR 1915 (SHEFFIELD RD.)
 MP 0.01 - MP 4.10
 SEE ALSO TYPICAL NO. 3

MAP NO. 5
 SR 1936 (GARLAND KING RD.)
 MP 0.02 - MP 1.68

Ⓥ *FRIS MILL 1-1/2"
 MP 1.90 - MP 1.95
 MP 1.97 - MP 2.06

MAP NO. 6
 SR 1945 (JACK DALE RD.)
 MP 1.05 - MP 2.10

PAVEMENT SCHEDULE

| | |
|----|---|
| C1 | PROP. APPROX. 1½" DEPTH ASPHALT CONCRETE SURFACE COURSE, TYPE S9.5C, AT AN AVERAGE RATE OF 168 LBS. PER SQ.YD. |
| C2 | PROP. APPROX. 1½" DEPTH ASPHALT CONCRETE SURFACE COURSE, TYPE S9.5B, AT AN AVERAGE RATE OF 165 LBS. PER SQ.YD. |
| C3 | PROP. APPROX. 1" DEPTH ASPHALT CONCRETE SURFACE COURSE, TYPE S9.5B, AT AN AVERAGE RATE OF 110.0 LBS. PER SQ.YD. |
| R1 | EXISTING CONCRETE BRIDGE RAIL |
| T1 | EARTH MATERIAL (SHOULDER RECONSTRUCTION) |
| T2 | EXISTING EARTH MATERIAL |
| U | EXISTING PAVEMENT |
| V1 | MILLING ASPHALT PAVEMENT, 1½" DEPTH |
| V2 | MILLING ASPHALT PAVEMENT, 1" DEPTH |

PAVEMENT EDGE SLOPES ARE 1:1, EXCEPT FINAL SURFACE COURSE. SEE SHOULDER WEDGE DETAIL.

NOTES: MILL A SINGLE LANE AND PAVE BACK BY THE END OF EACH WORK DAY.

SHOULDER WORK ON MAP NO. 1 - 6 AS NEEDED, TO BE DETERMINED BY ENGINEER.

REVISIONS

8/17/99

SYSTEMS DESIGN

DETAILS OF REPAIRING EXISTING PAVEMENT PRIOR TO RESURFACING FOR FULL DEPTH AND MILLING

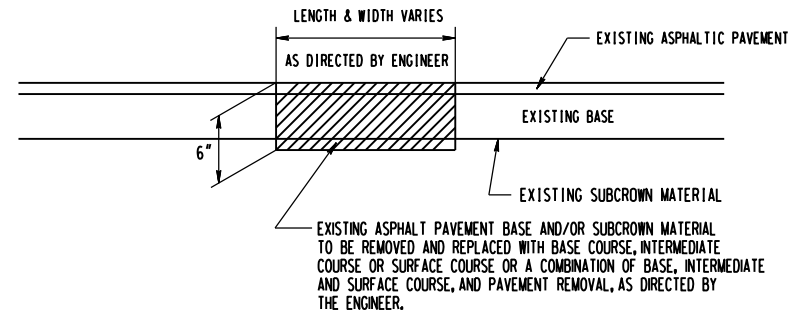

DETAIL NO. 1

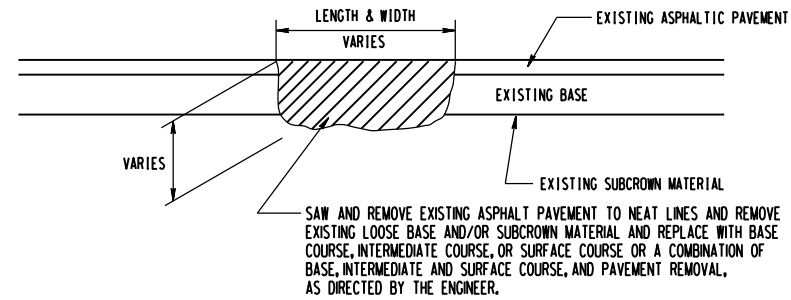

DETAIL NO. 2

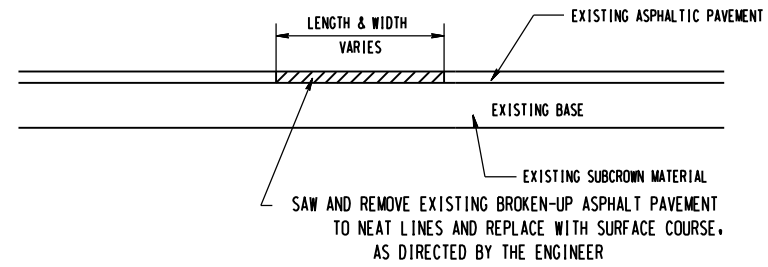

DETAIL NO. 3

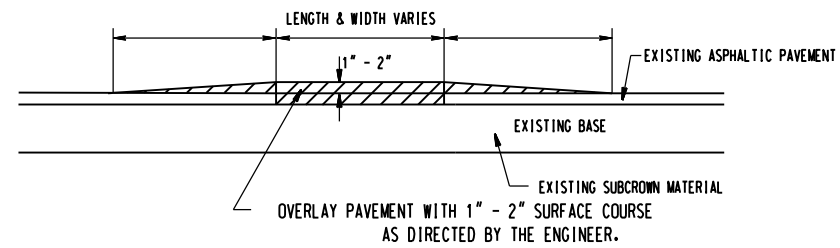

DETAIL NO. 4

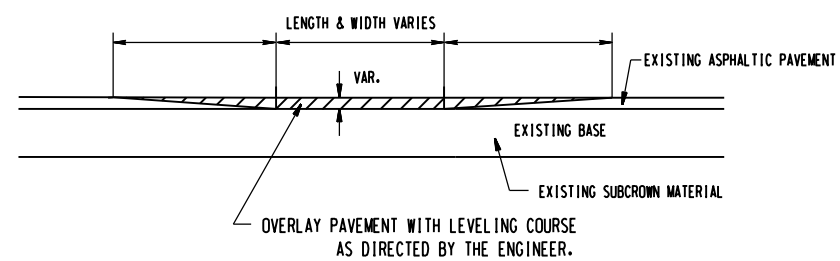

DETAIL NO. 5

REVISIONS

20-APP-2015-1156
 C:\Users\jmkim\OneDrive\Desktop\DETAIL_PSHS\Microstation_Files\3CR\20711173_Patch.dgn
 \$\$\$SUNFERN\$\$\$

- NOTES:
- 1) DETAIL DOES NOT APPLY TO OGAFC AND ULTRA-THIN BONDED WEARING COURSE.
 - 2) BACKFILL SHOULDER WITH APPROVED MATERIAL.
 - 3) THE SHOULDER WEDGE DEVICE MAY BE DISENGAGED AT PAVED DRIVEWAYS, SIDE STREETS, HIGH SHOULDERS, AND OTHER LOCATIONS NOT FEASIBLE TO CONSTRUCT AS APPROVED BY THE ENGINEER.

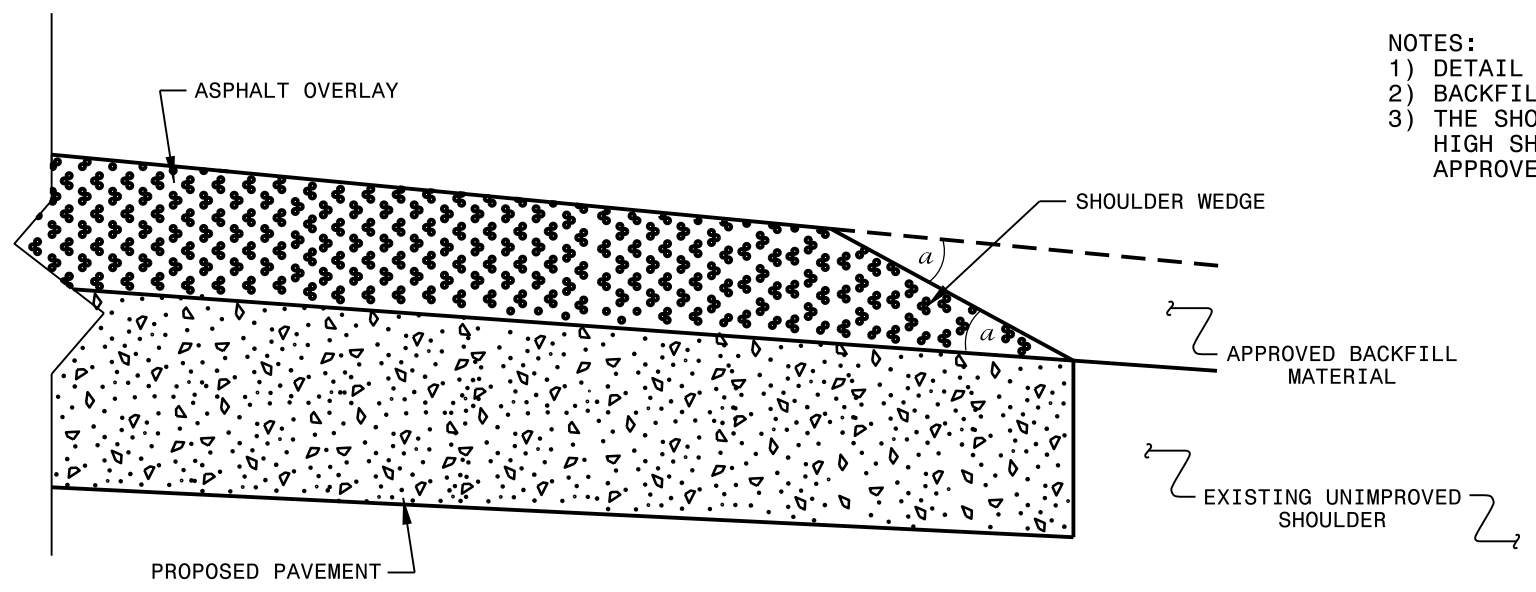

SHOULDER WEDGE DETAIL
 (Resurfacing Projects w/ Widening or
 with Existing Paved Shoulder having no dropoffs)

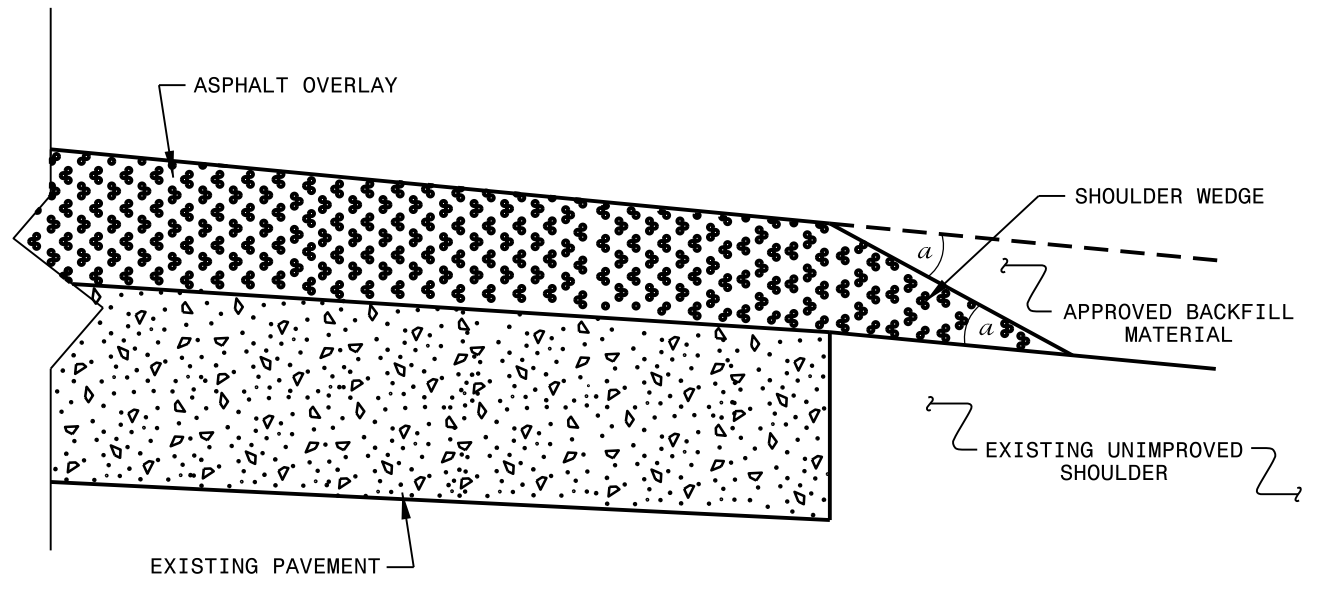

SHOULDER WEDGE DETAIL
 (Resurfacing Projects w/ NO Widening)

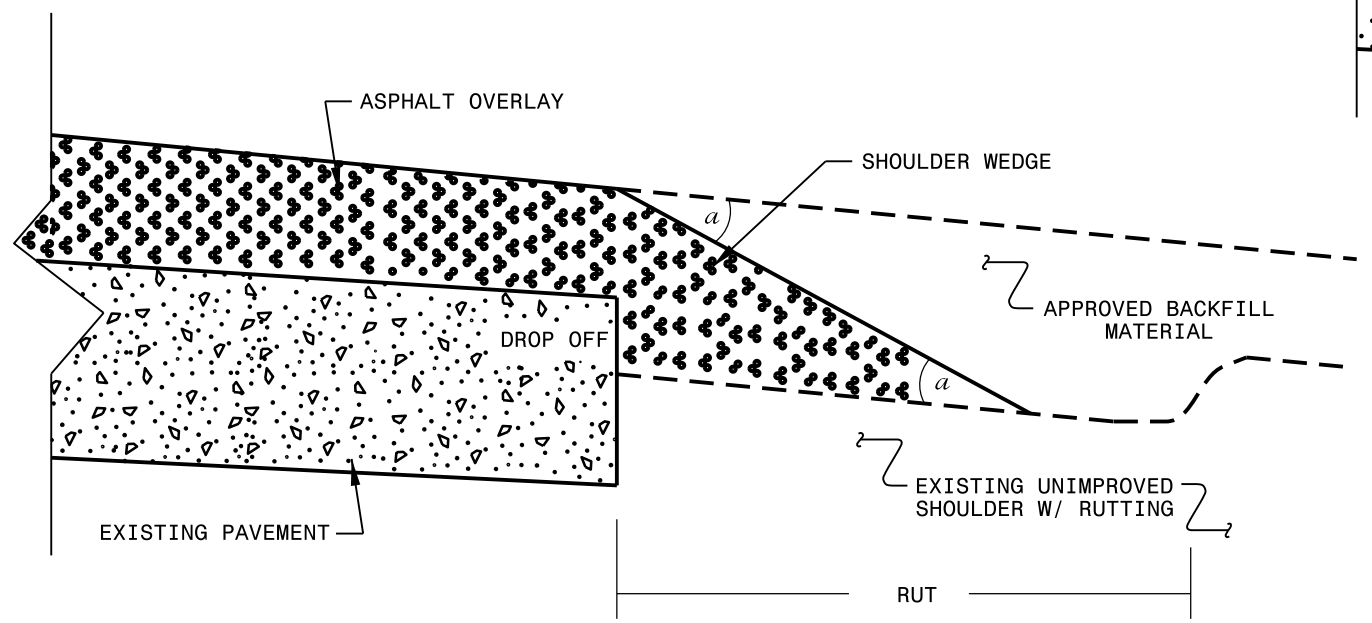

SHOULDER WEDGE DETAIL
 (Resurfacing Adjacent to
 Rutted Shoulder)

- SHOULDER WEDGE ANGLE = 30°

| | | | |
|--|---------------|------------------|--|
| CONTRACT STANDARDS AND DEVELOPMENT UNIT | | | |
| Office 919-707-6950 | | FAX 919-250-4119 | |
| SHOULDER WEDGE DETAILS | | | |
| ORIGINAL BY: T.SPELL | DATE: 7-19-11 | | |
| MODIFIED BY: | DATE: 2/2/16 | | |
| CHECKED BY: | DATE: | | |
| FILE SPEC.: s:\usr\details\stand\shoulderwedgedetail.dgn | | | |

27 JUN 2018 13:22 s:\projects\Resurfacing Projects\Division 3\Sampson August 2018\Revised Shoulder Wedge Detail.dgn
 P:\porter_41_CSD_2018_05_25

DIVISION OF HIGHWAYS
STATE OF NORTH CAROLINA

SOIL STABILIZATION TIMEFRAMES

| <i>SITE DESCRIPTION</i> | <i>STABILIZATION TIME</i> | <i>TIMEFRAME EXCEPTIONS</i> |
|--|---------------------------|--|
| PERIMETER DIKES, SWALES, DITCHES AND SLOPES | 7 DAYS | NONE |
| HIGH QUALITY WATER (HQW) ZONES | 7 DAYS | NONE |
| SLOPES STEEPER THAN 3:1 | 7 DAYS | IF SLOPES ARE 10' OR LESS IN LENGTH AND ARE NOT STEEPER THAN 2:1, 14 DAYS ARE ALLOWED. |
| SLOPES 3:1 OR FLATTER | 14 DAYS | 7 DAYS FOR SLOPES GREATER THAN 50' IN LENGTH. |
| ALL OTHER AREAS WITH SLOPES FLATTER THAN 4:1 | 14 DAYS | NONE, EXCEPT FOR PERIMETERS AND HQW ZONES. |

NOTES: Less than 5' - 10' undisturbed buffer from ROW, ditchline, water feature, or drainage inlet, add BMP.

BMP Options: Wattle or Silt Fence

EROSION CONTROL DETAIL

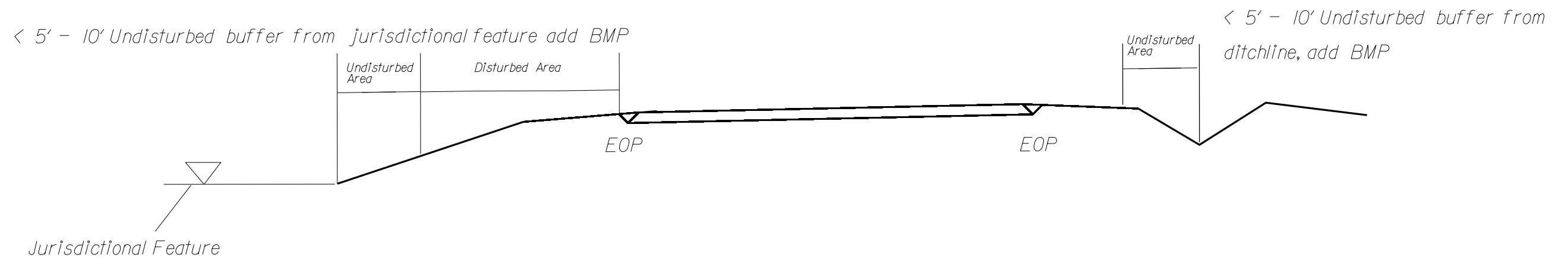
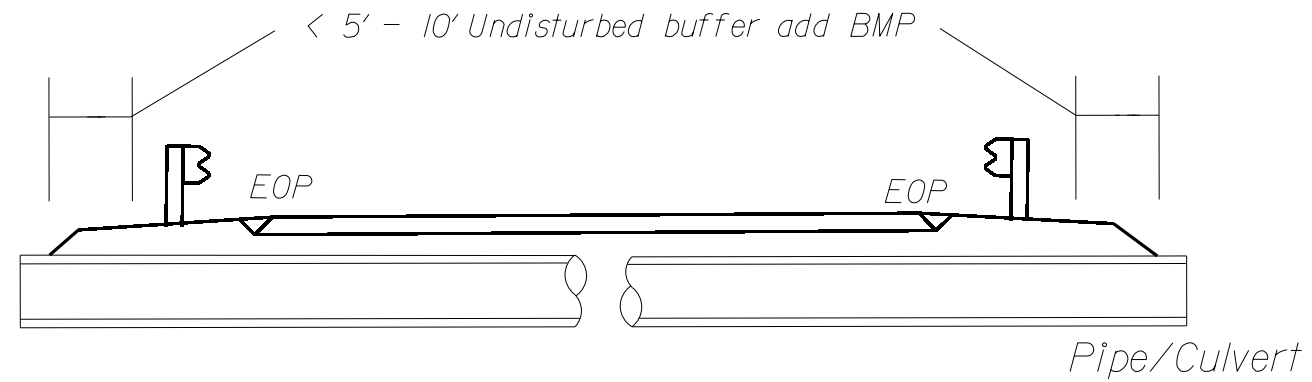

Use BMP's if shoulders and/or frontslopes and/or ditchline and/or backslopes are disturbed



< 5' - 10' Undisturbed buffer from inlet, add wattle

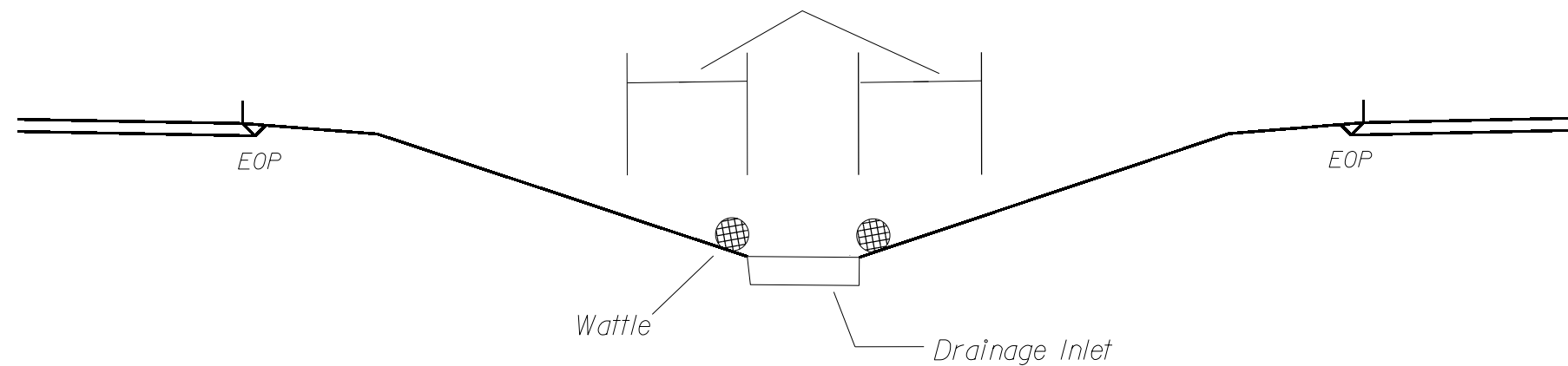

NOT TO SCALE

| | |
|---------------------------|-----------|
| PROJECT NO. | SHEET NO. |
| 2022CPT.03.04.10311, Etc. | 6 |

SUMMARY OF QUANTITIES

| PROJECT NO | COUNTY | MAP NO | ROUTE | DESCRIPTION | TYP NO | LANES | LANE TYPE | FINAL SURFACE TESTING REQUIRED | WARM MIX ASPHALT REQUIRED | LENGTH | WIDTH | 010600000-E | 122000000-E | 124500000-E | 129700000-E | | 133000000-E | 151900000-E | 152000000-E | 152300000-E | |
|---|--------|--------|--|---|--------|-------|-----------|--------------------------------|---------------------------|--------|--------------|-------------------|-----------------------|-------------------------|--------------|--------------|--------------------|-----------------------|------------------------|-----------------------|--------------|
| | | | | | | | | | | | | BORROW EXCAVATION | INCIDENTAL STONE BASE | SHOULDER RECONSTRUCTION | 1.5" MILLING | 1" MILLING | INCIDENTAL MILLING | SURFACE COURSE, S9.5B | LEVELING COURSE, S9.5B | SURFACE COURSE, S9.5C | |
| | | | | | | | | | | | MI | FT | CY | TON | SMI | SY | SY | SY | TON | TON | TON |
| 2022CPT.03.04.10311 | Duplin | 1 | NC 903 HIGHWAY NORTHBOUND (N. KENANSVILLE BYPASS)/ NC 11 HIGHWAY | FROM 0.04 MI. NORTH OF NC 24 HWY. TO 0.42 MILES N. OF NC 11 HWY./ NC 903 HWY. [MP 17.27 - MP 20.86] | 1 | 2 | 2WD | NO | NO | 1.49 | 31 | 216 | 12 | 2.56 | | | 1,143 | | | 2,145 | |
| TOTAL FOR MAP NO. 1 | | | | | | | | | | | 1.49 | | 216 | 12 | 2.56 | | | 1,143 | | | 2,145 |
| 2022CPT.03.04.10311 | Duplin | 2 | NC 11 HIGHWAY/ NC 903 HIGHWAY SOUTHBOUND (N. KENANSVILLE BYPASS) | FROM NC 11 HWY. /NC 903 HWY. TO 0.04 MI. NORTH OF NC 24 HWY. [MP 13.09 - MP 18.20] | 1 | 2 | 2WD | NO | NO | 1.52 | 31 | 189 | 12 | 2.48 | | | 1,300 | | | 2,299 | |
| TOTAL FOR MAP NO. 2 | | | | | | | | | | | 1.52 | | 189 | 12 | 2.48 | | | 1,300 | | | 2,299 |
| TOTAL FOR PROJ NO. 2022CPT.03.04.10311 | | | | | | | | | | | 3.01 | | 405 | 24 | 5.04 | | | 2,443 | | | 4,444 |
| 2022CPT.03.04.20311 | Duplin | 3 | SR 1368 (NORWOOD EZZELL ROAD) | FROM SR 1306 (BEAUTANCUS RD.) TO W. NC 403 HWY. [MP 0.02 - MP 3.36] | 2 | 2 | 2WU | NO | NO | 3.34 | 20 | 510 | 102 | 6.68 | | | 186 | 3,207 | 50 | | |
| TOTAL FOR MAP NO. 3 | | | | | | | | | | | 3.34 | | 510 | 102 | 6.68 | | | 186 | 3,207 | 50 | |
| 2022CPT.03.04.20311 | Duplin | 4 | SR 1915 (SHEFFIELD ROAD) | FROM SR 1141 (FIRETOWER RD.) TO S. US 117 HWY. [MP 0.01 - MP 4.10] | 2,3 | 2 | 2WU | NO | NO | 4.09 | 20 | 625 | 110 | 8.18 | 1,474 | 403 | 541 | 4,314 | 80 | | |
| TOTAL FOR MAP NO. 4 | | | | | | | | | | | 4.09 | | 625 | 110 | 8.18 | 1,474 | 403 | 541 | 4,314 | 80 | |
| 2022CPT.03.04.20311 | Duplin | 5 | SR 1936 (GARLAND KING ROAD) | FROM SR 1162 (BAY RD.) TO S. NC 11 HWY. [MP 0.02 - MP 1.68] | 2 | 2 | 2WU | NO | NO | 1.66 | 20 | 254 | 62 | 3.32 | | | 112 | 1,617 | 50 | | |
| TOTAL FOR MAP NO. 5 | | | | | | | | | | | 1.66 | | 254 | 62 | 3.32 | | | 112 | 1,617 | 50 | |
| 2022CPT.03.04.20311 | Duplin | 6 | SR 1945 (JACK DALE ROAD) | FROM SR 1944 (RIVENBARK TOWN RD.) TO S. NC 11 HWY. [MP 1.05 - MP 2.10] | 2 | 2 | 2WU | NO | NO | 1.05 | 20 | 160 | 62 | 2.10 | | | 112 | 1,023 | 50 | | |
| TOTAL FOR MAP NO. 6 | | | | | | | | | | | 1.05 | | 160 | 62 | 2.10 | | | 112 | 1,023 | 50 | |
| TOTAL FOR PROJ NO. 2022CPT.03.04.20311 | | | | | | | | | | | 10.14 | | 1,549 | 336 | 20.28 | 1,474 | 403 | 951 | 10,161 | 230 | |
| GRAND TOTAL | | | | | | | | | | | 13.15 | | 1,954 | 360 | 25.32 | 1,474 | 403 | 3,394 | 10,161 | 230 | 4,444 |

| | |
|---------------------------|-----------|
| PROJECT NO. | SHEET NO. |
| 2022CPT.03.04.10311, Etc. | 7 |
| | |

SUMMARY OF QUANTITIES

| PROJECT NO | COUNTY | MAP NO | ROUTE | DESCRIPTION | TYP NO | LANES | LANE TYPE | FINAL SURFACE TESTING REQUIRED | WARM MIX ASPHALT REQUIRED | LENGTH | WIDTH | 1575000000-E | | 1880000000-E | | 6000000000-E | 6009000000-E | 6012000000-E | 6015000000-E | 6018000000-E | |
|---|--------|--------|--|---|--------|-------|-----------|--------------------------------|---------------------------|--------|--------------|------------------------------|---|---|----------------------|----------------------|------------------------|--------------------|----------------------------|--------------|------------|
| | | | | | | | | | | | | ASPHALT BINDER FOR PLANT MIX | PATCHING EXISTING PAVEMENT (FULL DEPTH) GENERIC | PATCHING EXISTING PAVEMENT (MILL) GENERIC | TEMPORARY SILT FENCE | STONE FOR EC CLASS B | SEDIMENT CONTROL STONE | TEMPORARY MULCHING | SEED FOR TEMPORARY SEEDING | | |
| | | | | | | | | | | | MI | FT | TON | TON | TON | LF | TON | TON | ACR | LBS | |
| 2022CPT.03.04.10311 | Duplin | 1 | NC 903 HIGHWAY NORTHBOUND (N. KENANSVILLE BYPASS)/ NC 11 HIGHWAY | FROM 0.04 MI. NORTH OF NC 24 HWY. TO 0.42 MILES N. OF NC 11 HWY./ NC 903 HWY. [MP 17.27 - MP 20.86] | 1 | 2 | 2WD | NO | NO | 1.49 | 31 | 127 | | 180 | | 128 | 32 | 32 | 1.28 | 64 | |
| TOTAL FOR MAP NO. 1 | | | | | | | | | | | 1.49 | | 127 | | 180 | | 128 | 32 | 32 | 1.28 | 64 |
| 2022CPT.03.04.10311 | Duplin | 2 | NC 11 HIGHWAY/ NC 903 HIGHWAY SOUTHBOUND (N. KENANSVILLE BYPASS) | FROM NC 11 HWY. /NC 903 HWY. TO 0.04 MI. NORTH OF NC 24 HWY. [MP 13.09 - MP 18.20] | 1 | 2 | 2WD | NO | NO | 1.52 | 31 | 136 | | 220 | | 124 | 31 | 31 | 1.24 | 62 | |
| TOTAL FOR MAP NO. 2 | | | | | | | | | | | 1.52 | | 136 | | 220 | | 124 | 31 | 31 | 1.24 | 62 |
| TOTAL FOR PROJ NO. 2022CPT.03.04.10311 | | | | | | | | | | | 3.01 | | 263 | | 400 | | 252 | 63 | 63 | 2.52 | 126 |
| | | | | | | | | | | | 400 | | | | | | | | | | |
| 2022CPT.03.04.20311 | Duplin | 3 | SR 1368 (NORWOOD EZZELL ROAD) | FROM SR 1306 (BEAUTANCUS RD.) TO W. NC 403 HWY. [MP 0.02 - MP 3.36] | 2 | 2 | 2WU | NO | NO | 3.34 | 20 | 212 | 10 | 400 | | 334 | 84 | 84 | 3.34 | 167 | |
| TOTAL FOR MAP NO. 3 | | | | | | | | | | | 3.34 | | 212 | 10 | 400 | | 334 | 84 | 84 | 3.34 | 167 |
| 2022CPT.03.04.20311 | Duplin | 4 | SR 1915 (SHEFFIELD ROAD) | FROM SR 1141 (FIRETOWER RD.) TO S. US 117 HWY. [MP 0.01 - MP 4.10] | 2,3 | 2 | 2WU | NO | NO | 4.09 | 20 | 286 | | 250 | | 409 | 102 | 102 | 4.09 | 205 | |
| TOTAL FOR MAP NO. 4 | | | | | | | | | | | 4.09 | | 286 | | 250 | | 409 | 102 | 102 | 4.09 | 205 |
| 2022CPT.03.04.20311 | Duplin | 5 | SR 1936 (GARLAND KING ROAD) | FROM SR 1162 (BAY RD.) TO S. NC 11 HWY. [MP 0.02 - MP 1.68] | 2 | 2 | 2WU | NO | NO | 1.66 | 20 | 108 | | 100 | | 166 | 42 | 42 | 1.66 | 83 | |
| TOTAL FOR MAP NO. 5 | | | | | | | | | | | 1.66 | | 108 | | 100 | | 166 | 42 | 42 | 1.66 | 83 |
| 2022CPT.03.04.20311 | Duplin | 6 | SR 1945 (JACK DALE ROAD) | FROM SR 1944 (RIVENBARK TOWN RD.) TO S. NC 11 HWY. [MP 1.05 - MP 2.10] | 2 | 2 | 2WU | NO | NO | 1.05 | 20 | 70 | 25 | 200 | | 105 | 30 | 30 | 1.05 | 53 | |
| TOTAL FOR MAP NO. 6 | | | | | | | | | | | 1.05 | | 70 | 25 | 200 | | 105 | 30 | 30 | 1.05 | 53 |
| TOTAL FOR PROJ NO. 2022CPT.03.04.20311 | | | | | | | | | | | 10.14 | | 676 | 35 | 950 | | 1,014 | 258 | 258 | 10.14 | 508 |
| | | | | | | | | | | | 985 | | | | | | | | | | |
| GRAND TOTAL | | | | | | | | | | | 13.15 | | 939 | 35 | 1,350 | | 1,266 | 321 | 321 | 12.66 | 634 |
| | | | | | | | | | | | 1,385 | | | | | | | | | | |

| | |
|---------------------------|-----------|
| PROJECT NO. | SHEET NO. |
| 2022CPT.03.04.10311, Etc. | 8 |

SUMMARY OF QUANTITIES

| PROJECT NO | COUNTY | MAP NO | ROUTE | DESCRIPTION | TYP NO | LANES | LANE TYPE | FINAL SURFACE TESTING REQUIRED | WARM MIX ASPHALT REQUIRED | LENGTH | WIDTH | 602100000-E | 603600000-E | 604200000-E | 607101000-E | 608400000-E | 609000000-E | 609300000-E | 611700000-N | 744400000-E | |
|---|--------|--------|--|---|--------|-------|-----------|--------------------------------|---------------------------|--------|--------------|----------------------------------|-----------------------------|---------------------|-------------|-----------------|-------------------------|-------------------------------|------------------------------|-----------------------|------------|
| | | | | | | | | | | | | FERTILIZER FOR TEMPORARY SEEDING | MATting FOR EROSION CONTROL | 1/4" HARDWARE CLOTH | WATTLE | SEED & MULCHING | SEED FOR REPAIR SEEDING | FERTILIZER FOR REPAIR SEEDING | RESPONSE FOR EROSION CONTROL | INDUCTIVE LOOP SAWCUT | |
| | | | | | | | | | | | MI | FT | TON | SY | LF | LF | AC | LB | TON | EA | LF |
| 2022CPT.03.04.10311 | Duplin | 1 | NC 903 HIGHWAY NORTHBOUND (N. KENANSVILLE BYPASS)/ NC 11 HIGHWAY | FROM 0.04 MI. NORTH OF NC 24 HWY. TO 0.42 MILES N. OF NC 11 HWY./ NC 903 HWY. [MP 17.27 - MP 20.86] | 1 | 2 | 2WD | NO | NO | 1.49 | 31 | 0.32 | 10 | 64 | 20 | 1.24 | 64 | 0.32 | 4 | 280 | |
| TOTAL FOR MAP NO. 1 | | | | | | | | | | | 1.49 | | 0.32 | 10 | 64 | 20 | 1.24 | 64 | 0.32 | 4 | 280 |
| 2022CPT.03.04.10311 | Duplin | 2 | NC 11 HIGHWAY/ NC 903 HIGHWAY SOUTHBOUND (N. KENANSVILLE BYPASS) | FROM NC 11 HWY. /NC 903 HWY. TO 0.04 MI. NORTH OF NC 24 HWY. [MP 13.09 - MP 18.20] | 1 | 2 | 2WD | NO | NO | 1.52 | 31 | 0.31 | 10 | 62 | 20 | 1.20 | 62 | 0.31 | 4 | 700 | |
| TOTAL FOR MAP NO. 2 | | | | | | | | | | | 1.52 | | 0.31 | 10 | 62 | 20 | 1.20 | 62 | 0.31 | 4 | 700 |
| TOTAL FOR PROJ NO. 2022CPT.03.04.10311 | | | | | | | | | | | 3.01 | | 0.63 | 20 | 126 | 40 | 2.44 | 126 | 0.63 | 8 | 980 |
| 2022CPT.03.04.20311 | Duplin | 3 | SR 1368 (NORWOOD EZZELL ROAD) | FROM SR 1306 (BEAUTANCUS RD.) TO W. NC 403 HWY. [MP 0.02 - MP 3.36] | 2 | 2 | 2WU | NO | NO | 3.34 | 20 | 0.84 | 30 | 167 | 60 | 3.24 | 167 | 0.84 | 8 | | |
| TOTAL FOR MAP NO. 3 | | | | | | | | | | | 3.34 | | 0.84 | 30 | 167 | 60 | 3.24 | 167 | 0.84 | 8 | |
| 2022CPT.03.04.20311 | Duplin | 4 | SR 1915 (SHEFFIELD ROAD) | FROM SR 1141 (FIRETOWER RD.) TO S. US 117 HWY. [MP 0.01 - MP 4.10] | 2,3 | 2 | 2WU | NO | NO | 4.09 | 20 | 1.02 | 30 | 205 | 70 | 3.97 | 205 | 1.02 | 8 | | |
| TOTAL FOR MAP NO. 4 | | | | | | | | | | | 4.09 | | 1.02 | 30 | 205 | 70 | 3.97 | 205 | 1.02 | 8 | |
| 2022CPT.03.04.20311 | Duplin | 5 | SR 1936 (GARLAND KING ROAD) | FROM SR 1162 (BAY RD.) TO S. NC 11 HWY. [MP 0.02 - MP 1.68] | 2 | 2 | 2WU | NO | NO | 1.66 | 20 | 0.42 | 20 | 83 | 30 | 1.61 | 83 | 0.42 | 4 | | |
| TOTAL FOR MAP NO. 5 | | | | | | | | | | | 1.66 | | 0.42 | 20 | 83 | 30 | 1.61 | 83 | 0.42 | 4 | |
| 2022CPT.03.04.20311 | Duplin | 6 | SR 1945 (JACK DALE ROAD) | FROM SR 1944 (RIVENBARK TOWN RD.) TO S. NC 11 HWY. [MP 1.05 - MP 2.10] | 2 | 2 | 2WU | NO | NO | 1.05 | 20 | 0.26 | 20 | 60 | 20 | 1.02 | 53 | 0.26 | 2 | | |
| TOTAL FOR MAP NO. 6 | | | | | | | | | | | 1.05 | | 0.26 | 20 | 60 | 20 | 1.02 | 53 | 0.26 | 2 | |
| TOTAL FOR PROJ NO. 2022CPT.03.04.20311 | | | | | | | | | | | 10.14 | | 2.54 | 100 | 515 | 180 | 9.84 | 508 | 2.54 | 22 | |
| GRAND TOTAL | | | | | | | | | | | 13.15 | | 3.17 | 120 | 641 | 220 | 12.28 | 634 | 3.17 | 30 | 980 |

| | |
|---------------------------|-----------|
| PROJECT NO. | SHEET NO. |
| 2022CPT.03.04.10311, Etc. | 9 |

THERMOPLASTIC AND PAINT QUANTITIES

| PROJECT NO | COUNTY | MAP NO | ROUTE | DESCRIPTION | TYP NO | LANES | LANE TYPE | LENGTH | WIDTH | 4413000000-E | 4457000000-N | 4510000000-N | 4685000000-E | | 4700000000-E | |
|---|--------|--------|--|---|--------|-------|-----------|--------|--------------|---|---------------------------|-----------------|------------------------|-------------------------|--------------------------|------------|
| | | | | | | | | MI | FT | WORK ZONE ADVANCE/GENERAL WARNING SIGNING | TEMPORARY TRAFFIC CONTROL | LAW ENFORCEMENT | 4" X 90 M WHITE THERMO | 4" X 90 M YELLOW THERMO | 12" X 90 M YELLOW THERMO | |
| | | | | | | | | | SF | LS | HR | LF | LF | LF | | |
| 2022CPT.03.04.10311 | Duplin | 1 | NC 903 HIGHWAY NORTHBOUND (N. KENANSVILLE BYPASS)/ NC 11 HIGHWAY | FROM 0.04 MI. NORTH OF NC 24 HWY. TO 0.42 MILES N. OF NC 11 HWY./ NC 903 HWY. [MP 17.27 - MP 20.86] | 1 | 2 | 2WD | 1.49 | 31 | 96 | 0.12 | 40 | 8,589 | 6,642 | 140 | |
| TOTAL FOR MAP NO. 1 | | | | | | | | | 1.49 | | 96 | 0.12 | 40 | 8,589 | 6,642 | 140 |
| 2022CPT.03.04.10311 | Duplin | 2 | NC 11 HIGHWAY/ NC 903 HIGHWAY SOUTHBOUND (N. KENANSVILLE BYPASS) | FROM NC 11 HWY. /NC 903 HWY. TO 0.04 MI. NORTH OF NC 24 HWY. [MP 13.09 - MP 18.20] | 1 | 2 | 2WD | 1.52 | 31 | 176 | 0.12 | 40 | 10,339 | 8,026 | | |
| TOTAL FOR MAP NO. 2 | | | | | | | | | 1.52 | | 176 | 0.12 | 40 | 10,339 | 8,026 | |
| TOTAL FOR PROJ NO. 2022CPT.03.04.10311 | | | | | | | | | 3.01 | | 272 | 0.24 | 80 | 18,928 | 14,668 | 140 |
| | | | | | | | | | | | | | 33,596 | | | |
| 2022CPT.03.04.20311 | Duplin | 3 | SR 1368 (NORWOOD EZZELL ROAD) | FROM SR 1306 (BEAUTANCUS RD.) TO W. NC 403 HWY. [MP 0.02 - MP 3.36] | 2 | 2 | 2WU | 3.34 | 20 | 384 | 0.26 | | | | | |
| TOTAL FOR MAP NO. 3 | | | | | | | | | 3.34 | | 384 | 0.26 | | | | |
| 2022CPT.03.04.20311 | Duplin | 4 | SR 1915 (SHEFFIELD ROAD) | FROM SR 1141 (FIRETOWER RD.) TO S. US 117 HWY. [MP 0.01 - MP 4.10] | 2,3 | 2 | 2WU | 4.09 | 20 | 464 | 0.40 | | | | | |
| TOTAL FOR MAP NO. 4 | | | | | | | | | 4.09 | | 464 | 0.40 | | | | |
| 2022CPT.03.04.20311 | Duplin | 5 | SR 1936 (GARLAND KING ROAD) | FROM SR 1162 (BAY RD.) TO S. NC 11 HWY. [MP 0.02 - MP 1.68] | 2 | 2 | 2WU | 1.66 | 20 | | 0.08 | | | | | |
| TOTAL FOR MAP NO. 5 | | | | | | | | | 1.66 | | | 0.08 | | | | |
| 2022CPT.03.04.20311 | Duplin | 6 | SR 1945 (JACK DALE ROAD) | FROM SR 1944 (RIVENBARK TOWN RD.) TO S. NC 11 HWY. [MP 1.05 - MP 2.10] | 2 | 2 | 2WU | 1.05 | 20 | | 0.02 | | | | | |
| TOTAL FOR MAP NO. 6 | | | | | | | | | 1.05 | | | 0.02 | | | | |
| TOTAL FOR PROJ NO. 2022CPT.03.04.20311 | | | | | | | | | 10.14 | | 848 | 0.76 | | | | |
| GRAND TOTAL | | | | | | | | | 13.15 | | 1,120 | 1.00 | 80 | 18,928 | 14,668 | 140 |
| | | | | | | | | | | | | | 33,596 | | | |

| | |
|---------------------------|-----------|
| PROJECT NO. | SHEET NO. |
| 2022CPT.03.04.10311, Etc. | 10 |
| | |

THERMOPLASTIC AND PAINT QUANTITIES

| PROJECT NO | COUNTY | MAP NO | ROUTE | DESCRIPTION | TYP NO | LANES | LANE TYPE | LENGTH | WIDTH | 4725000000-E | | | | 4810000000-E | | 4850000000-E |
|---|--------|--------|--|---|--------|-------|-----------|--------------|-------|---------------|---------------|------------|---------------|----------------|----------------|-----------------------------------|
| | | | | | | | | | | THERMO LT | THERMO STR | MERGE | THERMO RT | 4" WHITE | 4" YELLOW | REMOVAL OF |
| | | | | | | | | | | ARROW 90 M | ARROW 90 M | ARROW 90 M | ARROW 90 M | PAINT | PAINT | PAVEMENT MARKING LINES (4") |
| | | | | | | | MI | FT | EA | EA | EA | EA | LF | LF | LF | |
| 2022CPT.03.04.10311 | Duplin | 1 | NC 903 HIGHWAY NORTHBOUND (N. KENANSVILLE BYPASS)/ NC 11 HIGHWAY | FROM 0.04 MI. NORTH OF NC 24 HWY. TO 0.42 MILES N. OF NC 11 HWY./ NC 903 HWY. [MP 17.27 - MP 20.86] | 1 | 2 | 2WD | 1.49 | 31 | 4 | 12 | 3 | | 2,770 | 2,210 | 2,490 |
| TOTAL FOR MAP NO. 1 | | | | | | | | 1.49 | | 4 | 12 | 3 | | 2,770 | 2,210 | 2,490 |
| 2022CPT.03.04.10311 | Duplin | 2 | NC 11 HIGHWAY/ NC 903 HIGHWAY SOUTHBOUND (N. KENANSVILLE BYPASS) | FROM NC 11 HWY. /NC 903 HWY. TO 0.04 MI. NORTH OF NC 24 HWY. [MP 13.09 - MP 18.20] | 1 | 2 | 2WD | 1.52 | 31 | 6 | 8 | | 4 | 2,770 | 2,210 | 2,490 |
| TOTAL FOR MAP NO. 2 | | | | | | | | 1.52 | | 6 | 8 | | 4 | 2,770 | 2,210 | 2,490 |
| TOTAL FOR PROJ NO. 2022CPT.03.04.10311 | | | | | | | | 3.01 | | 10 | 20 | 3 | 4 | 5,540 | 4,420 | 4,980 |
| | | | | | | | | | | 37 | | | | 9,960 | | |
| 2022CPT.03.04.20311 | Duplin | 3 | SR 1368 (NORWOOD EZZELL ROAD) | FROM SR 1306 (BEAUTANCUS RD.) TO W. NC 403 HWY. [MP 0.02 - MP 3.36] | 2 | 2 | 2WU | 3.34 | 20 | | | | | 70,612 | 35,486 | |
| TOTAL FOR MAP NO. 3 | | | | | | | | 3.34 | | | | | | 70,612 | 35,486 | |
| 2022CPT.03.04.20311 | Duplin | 4 | SR 1915 (SHEFFIELD ROAD) | FROM SR 1141 (FIRETOWER RD.) TO S. US 117 HWY. [MP 0.01 - MP 4.10] | 2,3 | 2 | 2WU | 4.09 | 20 | | | | | 86,598 | 45,180 | |
| TOTAL FOR MAP NO. 4 | | | | | | | | 4.09 | | | | | | 86,598 | 45,180 | |
| 2022CPT.03.04.20311 | Duplin | 5 | SR 1936 (GARLAND KING ROAD) | FROM SR 1162 (BAY RD.) TO S. NC 11 HWY. [MP 0.02 - MP 1.68] | 2 | 2 | 2WU | 1.66 | 20 | | | | | 35,060 | 16,188 | |
| TOTAL FOR MAP NO. 5 | | | | | | | | 1.66 | | | | | | 35,060 | 16,188 | |
| 2022CPT.03.04.20311 | Duplin | 6 | SR 1945 (JACK DALE ROAD) | FROM SR 1944 (RIVENBARK TOWN RD.) TO S. NC 11 HWY. [MP 1.05 - MP 2.10] | 2 | 2 | 2WU | 1.05 | 20 | | | | | 22,596 | 16,188 | |
| TOTAL FOR MAP NO. 6 | | | | | | | | 1.05 | | | | | | 22,596 | 16,188 | |
| TOTAL FOR PROJ NO. 2022CPT.03.04.20311 | | | | | | | | 10.14 | | | | | | 214,866 | 113,042 | |
| | | | | | | | | | | 37 | | | | 327,908 | | |
| GRAND TOTAL | | | | | | | | 13.15 | | 10 | 20 | 3 | 4 | 220,406 | 117,462 | 4,980 |
| | | | | | | | | | | 37 | | | | 337,868 | | |

| | |
|---------------------------|-----------|
| PROJECT NO. | SHEET NO. |
| 2022CPT.03.04.10311, Etc. | 11 |

THERMOPLASTIC AND PAINT QUANTITIES

| PROJECT NO | COUNTY | MAP NO | ROUTE | DESCRIPTION | TYP NO | LANES | LANE TYPE | LENGTH | WIDTH | 4891000000-E | 4895000000-N | | 4900000000-N | | |
|---|--------|--------|--|---|--------|-------|-----------|--------|--------------|-------------------------|---|---|-----------------------|-------------------------|------------|
| | | | | | | | | | | 24" X 90 M WHITE THERMO | NON CAST IRON SNOW PLOWABLE MARKERS (Y/Y) | NON CAST IRON SNOW PLOWABLE MARKERS (C/R) | CRYSTAL & RED MARKERS | YELLOW & YELLOW MARKERS | |
| | | | | | | | | | MI | FT | LF | EA | EA | EA | EA |
| 2022CPT.03.04.10311 | Duplin | 1 | NC 903 HIGHWAY NORTHBOUND (N. KENANSVILLE BYPASS)/ NC 11 HIGHWAY | FROM 0.04 MI. NORTH OF NC 24 HWY. TO 0.42 MILES N. OF NC 11 HWY./ NC 903 HWY. [MP 17.27 - MP 20.86] | 1 | 2 | 2WD | 1.49 | 31 | | 75 | 105 | 14 | | |
| TOTAL FOR MAP NO. 1 | | | | | | | | | 1.49 | | | 75 | 105 | 14 | |
| 2022CPT.03.04.10311 | Duplin | 2 | NC 11 HIGHWAY/ NC 903 HIGHWAY SOUTHBOUND (N. KENANSVILLE BYPASS) | FROM NC 11 HWY. /NC 903 HWY. TO 0.04 MI. NORTH OF NC 24 HWY. [MP 13.09 - MP 18.20] | 1 | 2 | 2WD | 1.52 | 31 | 30 | | 133 | 14 | 16 | |
| TOTAL FOR MAP NO. 2 | | | | | | | | | 1.52 | | 30 | | 133 | 14 | 16 |
| TOTAL FOR PROJ NO. 2022CPT.03.04.10311 | | | | | | | | | 3.01 | | 30 | 75 | 238 | 28 | 16 |
| | | | | | | | | | | | 313 | 44 | | | |
| 2022CPT.03.04.20311 | Duplin | 3 | SR 1368 (NORWOOD EZZELL ROAD) | FROM SR 1306 (BEAUTANCUS RD.) TO W. NC 403 HWY. [MP 0.02 - MP 3.36] | 2 | 2 | 2WU | 3.34 | 20 | | | | | 230 | |
| TOTAL FOR MAP NO. 3 | | | | | | | | | 3.34 | | | | | 230 | |
| 2022CPT.03.04.20311 | Duplin | 4 | SR 1915 (SHEFFIELD ROAD) | FROM SR 1141 (FIRETOWER RD.) TO S. US 117 HWY. [MP 0.01 - MP 4.10] | 2,3 | 2 | 2WU | 4.09 | 20 | | | | | 280 | |
| TOTAL FOR MAP NO. 4 | | | | | | | | | 4.09 | | | | | 280 | |
| 2022CPT.03.04.20311 | Duplin | 5 | SR 1936 (GARLAND KING ROAD) | FROM SR 1162 (BAY RD.) TO S. NC 11 HWY. [MP 0.02 - MP 1.68] | 2 | 2 | 2WU | 1.66 | 20 | | | | | 110 | |
| TOTAL FOR MAP NO. 5 | | | | | | | | | 1.66 | | | | | 110 | |
| 2022CPT.03.04.20311 | Duplin | 6 | SR 1945 (JACK DALE ROAD) | FROM SR 1944 (RIVENBARK TOWN RD.) TO S. NC 11 HWY. [MP 1.05 - MP 2.10] | 2 | 2 | 2WU | 1.05 | 20 | | | | | 75 | |
| TOTAL FOR MAP NO. 6 | | | | | | | | | 1.05 | | | | | 75 | |
| TOTAL FOR PROJ NO. 2022CPT.03.04.20311 | | | | | | | | | 10.14 | | | | | 695 | |
| | | | | | | | | | | | 695 | | | | |
| GRAND TOTAL | | | | | | | | | 13.15 | | 30 | 75 | 238 | 28 | 711 |
| | | | | | | | | | | | 313 | 739 | | | |

SIGNING FOR RESURFACING PROJECTS

LEGEND

┃ STATIONARY SIGN

← DIRECTION OF TRAFFIC FLOW

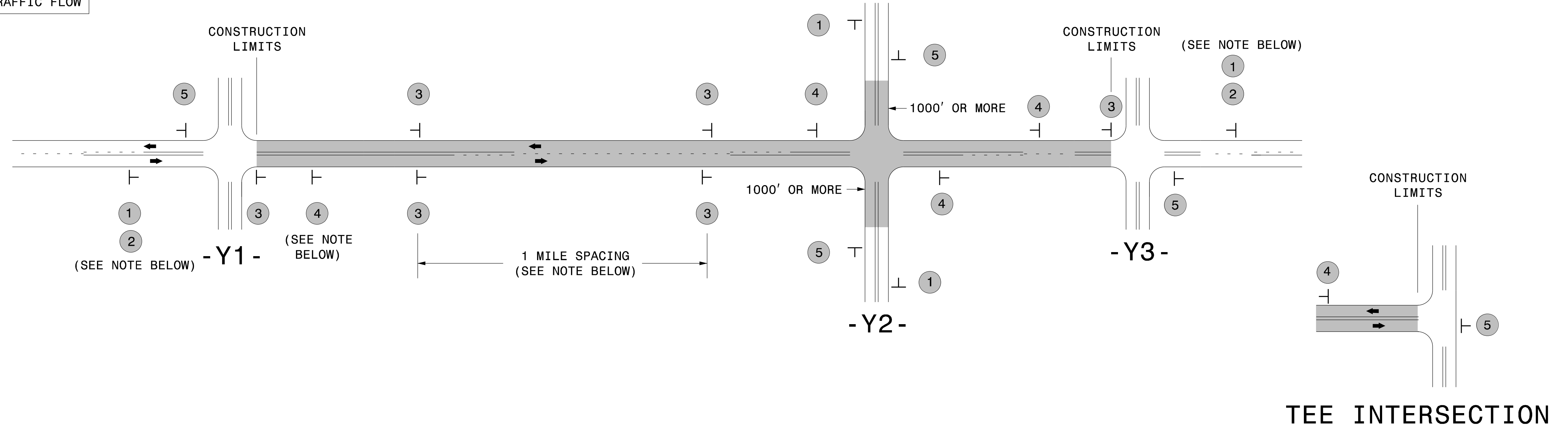

MAINLINE (-L-) SIGNING

-Y- LINE SIGNING

| | | | | |
|---|---|--|---|---|
| SIGNING NOTES AND PLACEMENT PER DIRECTION | 1 | | PLACE 1000' PRIOR TO BEGINNING OF CONSTRUCTION LIMITS. ONLY USED ON -Y- LINES IF RESURFACING LIMITS EXTEND 1000' ALONG -Y- LINE. | <p>NO REQUIRED STATIONARY SIGNING FOR THE FOLLOWING -Y- LINE CONDITIONS:</p> <ol style="list-style-type: none"> 1) LESS THAN 1000' OF RESURFACING ALONG -Y- LINE 2) SUBDIVISION ROADS 3) DEAD END ROADS <p>WHEN PAVING/CONSTRUCTION ACTIVITIES PROCEED ACROSS AN UNSIGNED -Y- LINE, PORTABLE ADVANCE WARNING SIGNS SHALL BE USED ALONG THE -Y- LINE AS SHOWN BELOW. REMOVE UPON COMPLETION OF WORK.</p> <div style="display: flex; justify-content: space-around;"> <div style="text-align: center;"> W20-1 48" X 48" PLACED 500' IN ADVANCE OF FLAGGER. </div> <div style="text-align: center;"> W20-7 A 48" X 48" PLACED 250' IN ADVANCE OF FLAGGER. </div> </div> |
| | 2 | | #2 SIGN ONLY USED WHEN CONSTRUCTION LIMITS ARE 2 OR MORE MILES IN LENGTH. ROUND UP TO NEXT WHOLE NUMBER. (NO FRACTIONAL OR DECIMAL NUMBERS) | |
| | 3 | | - PLACE INITIALLY AT THE CONSTRUCTION LIMITS AND SPACE 1 MILE APART THEREAFTER. - AT TEE INTERSECTIONS INSTALL INITIALLY 1/2 MILE FROM INTERSECTION AND SPACE 1 MILE APART THEREAFTER. | |
| | 4 | | - THESE ARE FOR -Y- LINES THAT ARE "THROUGH" ROADWAYS. - DEAD END AND SUBDIVISION ROADS ARE NOT "THROUGH" ROADWAYS. - INSTALL 500' +/- FROM EACH -Y- LINE APPROACH AS SHOWN ABOVE. - FOR MULTIPLE -Y- LINES THAT ARE SEPARATED BY 0.25 MILES OR LESS, TREAT AS A SINGLE UNIT AND INSTALL WITHIN 500' OF EACH APPROACH. - A MAXIMUM OF 2 SIGN SETS PER MILE. DO NOT INSTALL WHEN -Y- LINES ARE WITHIN 0.5 MILES FROM "END ROAD WORK" SIGN. - FOR TEE INTERSECTIONS, INSTALL WITHIN 500' +/- OF THE INTERSECTION ALONG -L- LINE. | |
| | 5 | | PLACE 500' FOLLOWING THE END OF CONSTRUCTION LIMITS OR AS SHOWN WHEN WORK ENDS AT A 3-WAY TEE INTERSECTION. | |

THE ABOVE SIGNS ARE ALL THAT ARE REQUIRED FOR A CONTRACTOR TO BEGIN A RESURFACING CONTRACT. ANY ADDITIONAL SIGNS REQUESTED BY NCDOT DIVISIONS SHALL BE INSTALLED WITHIN 7 BUSINESS DAYS OF THE START OF CONTRACT WORK.

MAPS LESS THAN 2 MILES

FOR RESURFACING MAPS WITH CONSTRUCTION LIMITS LESS THAN 2 MILES IN LENGTH, NO STATIONARY SIGNS ARE REQUIRED. USE PORTABLE "ROAD UNDER CONSTRUCTION" OR "ROAD WORK AHEAD" SIGNS IN LIEU OF STATIONARY ADVANCE WARNINGS SIGNS.

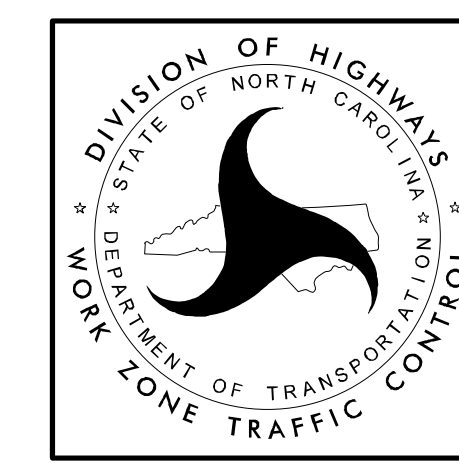

ADVANCE WARNING SIGNS FOR RURAL AND SUBURBAN 2-LANE ROADWAY RESURFACING